

图形符号 Symbol



▲ 订购码 Order Code

HYCT-63X100-200-S-LB

固定型式
mounting style

磁环代号
Magnet Code

行程2
Stroke2

行程1
Stroke1

缸径
Bore

型号Type

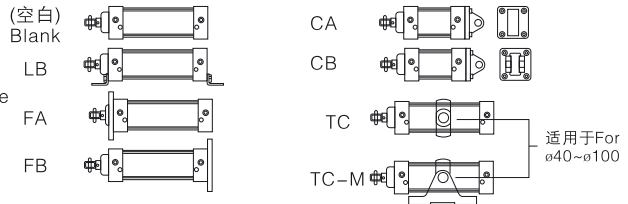

S: 附磁环
空白: 不附磁
S: With Magnet
Blank: without magnet

适用于For
ø40~ø100

HYCT-多位置双动型(拉杆式)(f32 ~ f200)
HYCT: Double action/tow stage(Tie rod)(f32 ~ f200)
HYUT: 米字型缸筒多位置双动型(f32 ~ f100)
HYUT: Double action/tow stage
(Cylinder tube shape is"米")(f32 ~ f100)

※特殊行程请与本公司联系
※Special stroke contact us

▲ 产品规格 Specifications

缸径(mm) Bore	32	40	50	63	80	100	125	160	200
动作型式 Action model	双动型Double Action								
工作介质 Working Fluid	空气 Air								
固定型式 Mounting Type	基本型 FA型 FB型 Basis style FA type FB type LB type								
工作压力MPa Working Pressure MPa	0.1—0.9MPa								
耐压MPa Proof Working MPa	1.5MPa								
工作温度℃ Working temperature℃	0 ~ 60								
工作速度mm / s Working speed range mm / s	50 ~ 800						50~500		
缓冲型式 Cushion Type	可调缓冲Adjustable Cushion								
缓冲行程mm Cushion stroke mm	24				32				
接管口径 Port Size	PT1 / 8	PT1 / 4	PT3 / 8	PT1 / 2	PT3 / 4				

▲ 行程 Stroke

缸径(mm) Bore	标准行程Standard Stroke	最大行程 Max Stroke	容许行程 Stroke Tolerance
32	25 50 75 80 100 125 150 160 175 200 300 350 400 500	1000	2000
40	25 50 75 80 100 125 150 160 175 200 300 350 400 500	1200	2000
50	25 50 75 80 100 125 150 160 175 200 300 350 400 500	1200	2000
63	25 50 75 80 100 125 150 160 175 200 300 350 400 500	1500	2000
80	25 50 75 80 100 125 150 160 175 200 300 350 400 500	1500	2000
100	25 50 75 80 100 125 150 160 175 200 300 350 400 500	1500	2000
125	25 50 75 80 100 125 150 160 175 200 250 300 350 400 450 500 600 700 800 900 1000	1500	2000
160	25 50 75 80 100 125 150 160 175 200 250 300 350 400 450 500 600 700 800 900 1000 1200 1500	2000	2500
200	25 50 75 80 100 125 150 160 175 200 250 300 350 400 450 500 600 700 800 900 1000 1200 1500	2000	2500

B

HYC
HYCD
HYCJ
HYCT
HYC
MBB
QGA(B)
CA1
CS1
DNC
SDA
SDAD
SDAJ
SDAT
SDAW
SDA
CQS
CQ2
ADVU
MAL
MSAL
MALD
MALJ
MAL
MA MAC
MSA
MAD
MAJ
MAR
MA
CJ2
CM2
DSNU
CU
TN
CXs
CXSW
MGP
CJP
CY1B(S)
MH
ZH

▲ 举例 Typical Example

1) 欲订购缸径为80mm, 行程1为50mm, 行程2为200mm, 附磁, 采用LB固定型式的多位置复动型(拉杆式)气缸, 其正确的订购码代号为: SCT-80×50x200-S-LB。

2) 欲订购缸径为50mm, 行程1为150mm, 行程2为300mm, 不附磁, 采用FA固定型式的多位置复动型(拉杆式)气缸, 其正确的订购码代号为: SCJ-50×150x300-FA。

1) Model: SCT-80×50x200-S-LB Bore: 80mm Stroke: 50mm Stroke2: 200mm with magnet
Adjustable stroke: Type: tow stage double action (tie rod) Mounting: LB style.

2) Model: SCT-50×150×300-FA Bore: 50mm Stroke: 150mm Stroke2: 300mm without magnet Adjustable stroke: Type: tow stage, double action (tie rod) Mounting: FA style.

▲ 内部结构 Internal Structure

不附磁 Without magnet

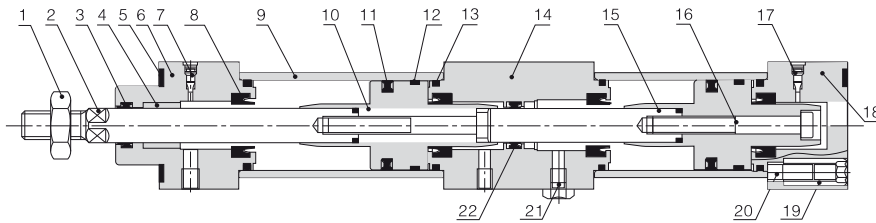

序号No.	名称	Part name
1	螺母 Nut	
2	活塞杆Piston rod	
3	前盖密封圈Rod packing	
4	含油轴承 Bush	
5	防护盖板 Protection board	
6	前盖 Rod cover	

序号No.	名称	Part name	序号No.	名称	Part name	序号No.	名称	Part name
7	缓冲防漏O形圈Cushion "o" ring		13	管壁O形圈Cover gasket		19	拉杆螺帽 Tie nut	
8	缓冲密封圈Cushion packing		14	中间体 Middle cover		20	拉杆 Tie rod	
9	缸筒 Cylinder tube		15	活塞杆O形圈Piston rod "O" ring		21	消声器 Muffler	
10	活塞双O形圈Piston seal		16	内六角螺栓 Bolt		22	连接座密封圈Middle cover gasket	
11	活塞 Piston		17	缓冲调整螺钉cushion needle				
12	耐磨环 Wear ring		18	后盖 Head cover				

缸径(mm)Bore	32	40	50	63	80	100	125	160	200
缸筒 Cylinder tube	铝合金Aluminum alloy							低碳钢Steel	
活塞 Piston	铝合金Aluminum alloy							铸铁Castiron	
活塞杆 Piston rod	高碳钢(镀硬铬研磨处理)Steel(Industrial chrome plated)								
前盖密封圈 Rod seal	NBR								
活塞双O形圈 Piston seal	NBR								
管壁O形圈 Cover gasket	NBR								
活塞杆O形圈 rod "O" ring	NBR								
缓冲密封圈 Cushion seal	NBR								
防漏O形圈 Cushion "O" ring	NBR								
含油轴承 Bush	含油粉末冶铜Oil impregnated bearing alloy								

缸径(mm)Bore	32	40	50	63	80	100	125	160	200
前盖 Rod cover	铝合金Aluminum alloy								
后盖 Head cover	铝合金Aluminum alloy								
磁环 Magnet	塑胶 Plastic magnet								
LB支架 LB bracket	低碳钢				Steel				
连接座 Middle cover	铝合金Aluminum alloy								
内六角螺栓 Bolt	中碳钢				Steel				
拉杆 Tie rod	低碳钢				Steel				
拉杆螺帽 Tie nut	低碳钢				Steel				
耐磨环 Wear ring	F4cu				Copper				
缓冲螺钉 Cushion needle	铜				Copper				

▲ 外形尺寸(毫米) Overall Dimension(mm)

φ32~φ200

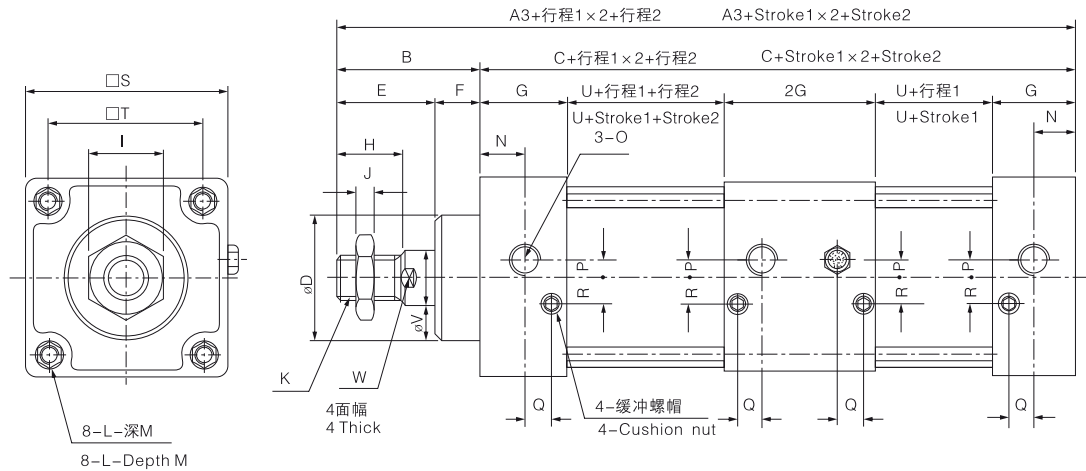

缸径 Bore	A3	B	C	D	E	F	G	H	I	J	K	L
32	233	47	186	28	32	15	27.5	22	17	6	M10x1.25	M6x1
40	235	49	186	32	34	15	27.5	24	17	7	M12x1.25	M6x1
50	243	57	186	38	42	15	27.5	32	23	8	M16x1.5	M6x1
63	249	57	192	38	42	15	27.5	32	23	8	M16x1.5	M8x1.25
80	291	75	216	47	54	21	33	40	26	10	M20x1.5	M10x1.5
100	303	75	228	47	54	21	33	40	26	10	M20x1.5	M10x1.5
125	409	119	290	60	87	32	40	54	41	13.5	M27x2	M12x1.75
160	512	152	360	65	104	48	45	72	55	18	M36x2	M16x2
200	527	167	360	75	117	50	50	72	55	18	M36x2	M16x2

缸径 Bore	M	N	O	P	Q	R	S	T	V	U	W
32	9.5	14	G1/8"	4.5	7	6	45	33	12	38	10
40	9.5	14	G1/4"	6	7	8.5	50	37	16	38	14
50	9.5	14	G1/4"	7	7	8.5	62	47	20	38	17
63	9.5	14	G3/8"	7	7	8.5	75	56	20	41	17
80	11.5	17	G3/8"	10.5	9	14.5	94	70	25	42	22
100	11.5	17	G1/2"	10.5	9.5	14.5	112	84	25	48	22
125	15	20.5	G1/2"	11	11	14.5	140	110	32	65	27
160	20	25	G3/4"	—	—	—	180	140	40	90	36
200	20	25	G3/4"	—	—	—	220	175	40	80	36

※附磁环与不附磁环之尺寸相同。
※The with/without magnet dimension is the same.

- B
- HYC
- HYCD
- HYCJ
- HYCT**
- HYC
- MBB
- QGA(B)
- CA1
- CS1
- DNC
- SDA
- SDAD
- SDAJ
- SDAT
- SDAW
- SDA
- CQS
- CQ2
- ADVU
- MAL
- MSAL
- MALD
- MALJ
- MAL
- MA MAC
- MSA
- MAD
- MAJ
- MAR
- MA
- CJ2
- CM2
- DSNU
- CU
- TN
- CXS
- CXSW
- MGP
- CJP
- CY1B(S)
- MH
- ZH